

SAFFER LIGHTING PROJECT

SEATTLE, WASHINGTON

SOPHIA MONFERRATO

THE MARRIED COUPLE

CLIENT PROFILE

Sophia: 32 years old

Works as an Interior Designer. She works mainly in an offsite studio and occasionally works from home on her computer.

Habits: Starts her day around 9am, but prefers to work during the night. She likes to read, care for her garden, cook and entertain.

Alec: 31 years old

Works as an Aerospace Engineer for Northrop Grumman. He works from home most of the time and goes into the office a couple times a month. Due to the nature of his work, an office space dedicated to him is needed.

Habits: Starts his day around 9am and works until around 6pm. He likes to partake in outdoor activities, 3D modelling, cooking and entertaining.



GET TO KNOW THEM

Being that both clients work from home, whether it is every day or sporadically, lighting choices are key to setting a comfortable, serene mood that promotes productivity. Client's have an office room in their home, but also enjoy working around their space. In order to create a comfortable working environment throughout the home, task lighting will be an important aspect to incorporate in the design. They both start their days around 9am and prefer to be working around their home illuminated by natural light - windows and doors will need to be large and made of glass in order to allow this to occur in their space.

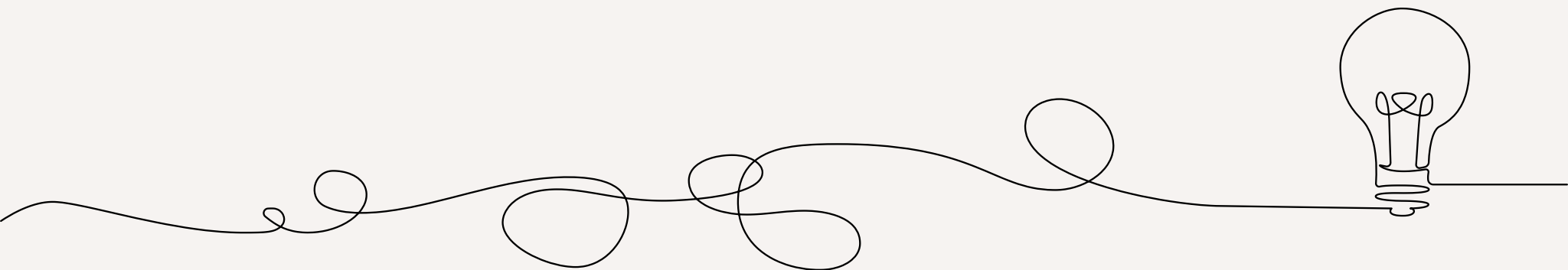

LIGHTING PLAN

Clients prefer softer light, which is why they have requested a variety of options for task lighting. Task lighting placed around/over desks, the dining table and reading nook will provide plenty of intentional light over work spaces. In regards to displaying their artwork throughout the space, decorative accent lighting will serve the purpose of illuminating the pieces, as well as provide additional statement pieces to contribute to the decorative aspect of the walls. Being that a main hobby shared by both clients is cooking, the kitchen will need to be sufficiently illuminated. By providing a dimmer in the kitchen and dining area, these areas will have the options to either be brightly lit or have a softer light emit over the space - good for hosting or showcasing a large meal or setting a calmer mood for casual dining or meal prep. Being that their aesthetic is considered traditional, the lamps and other sources of task lighting will be neutral colors and slightly textured to match the vibe of the rest of the space.

MOOD BOARD



ENTRY



NATURAL LIGHT

Two windows in the entryway allow for natural light to pour into the space, illuminating it throughout the day. The mood is open, inviting, clean, and fresh.

DECORATIVE/AMBIENT LIGHT

The hanging ceiling light serves as a statement piece when you walk into the home - setting the overall mood of coziness and warmth. The ceiling light also serves as ambient lighting for the hallway into the home.

ACCENT LIGHT

The wall sconces placed are used to illuminate the artwork featured in the space and provide additional accent light to slightly illuminate the space.

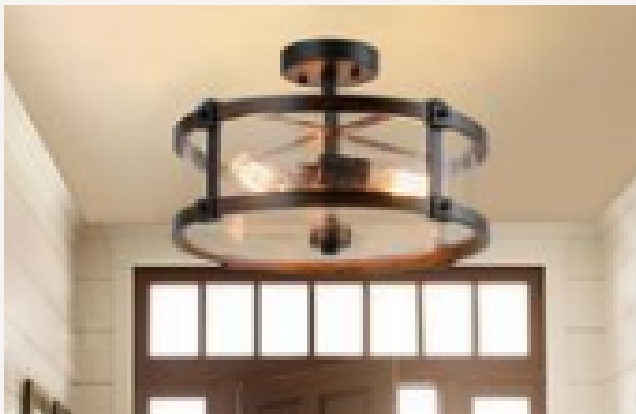

LIVING ROOM



NATURAL LIGHT

Large windows in the NW corner of the space allow for natural light to pour into the space, illuminating it throughout the day. The mood is open, inviting, clean, and fresh.

TASK/AMBIENT LIGHT

The standing light in the reading nook allows for a cozy spot to be independently lit. Recessed lighting provides ample light to illuminate the space.



ACCENT LIGHT

The wall sconces placed are used to illuminate the artwork featured in the space and provide additional accent light to slightly illuminate the space.

DINING ROOM



NATURAL LIGHT

Large french doors allow for natural light to pour into the space, illuminating it throughout the day. The mood is open, inviting, clean, and fresh.

DECORATIVE/AMBIENT LIGHT

The ceiling light above the table serves as a statement piece, as well as providing sufficient light directly above. Recessed lighting provides ample light to illuminate the space.

ACCENT LIGHT

The wall sconces placed are used to illuminate the artwork featured in the space and provide additional accent light to slightly illuminate the space.

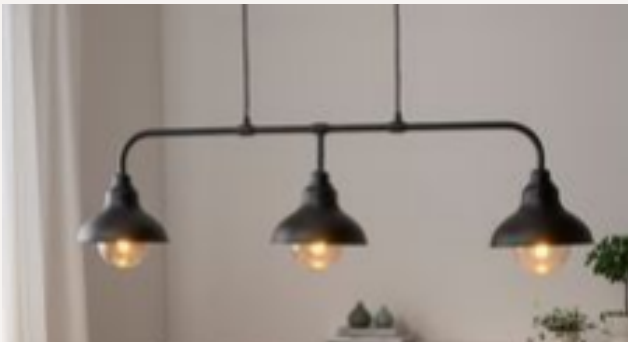

KITCHEN



TASK LIGHT

The pendants over the island provide direct light over the area, adding class to the overall mood with the design of the fixtures.

AMBIENT LIGHT

Recessed lighting provides ample light to illuminate the space.

ACCENT LIGHT

The under cabinet LED lights provide a decorative aspect to the illumination in the kitchen. They serve as night lights, as well as can be used as task lighting over any specific section of the counter.



OFFICE



NATURAL LIGHT

Large french doors allow for natural light to pour into the space, illuminating it throughout the day. The mood is open, inviting, clean, and fresh.

TASK LIGHT

The several desk lamps placed on the work space allow for the client to work without the brighter light from the recessed lighting, and focus more on a specific area of the desk they are working on.

AMBIENT LIGHT

Recessed lighting provides ample light to illuminate the space. The ceiling fan also serves as an option for ambient light.



MASTER BEDROOM



NATURAL LIGHT

Large windows allow for natural light to pour into the space, illuminating it throughout the day. The mood is open, inviting, clean, and fresh.

TASK/DECORATIVE LIGHT

The bedside table light fixtures allow for each side of the bed to be illuminated sufficiently to read a book or do work. The hanging ceiling light serves as a statement piece when you walk into the room - setting the mood to be elegant and warm. The fixture also provides ambient light for the room.

· AMBIENT LIGHT

Recessed lighting provides ample light to illuminate the space.



MASTER BATHROOM



NATURAL LIGHT

The windows in the toilet room and at the top of the shower allow for minimal natural light to illuminate the space.

ACCENT LIGHT

The pendant lights in between the vanity allow for specific light over the sink/mirror area of the space. It provides minimal light in the space, which is good for late-night trips to the beautiful space.

.

AMBIENT LIGHT

Recessed lighting provides ample light to illuminate the space.

LIGHT MAP

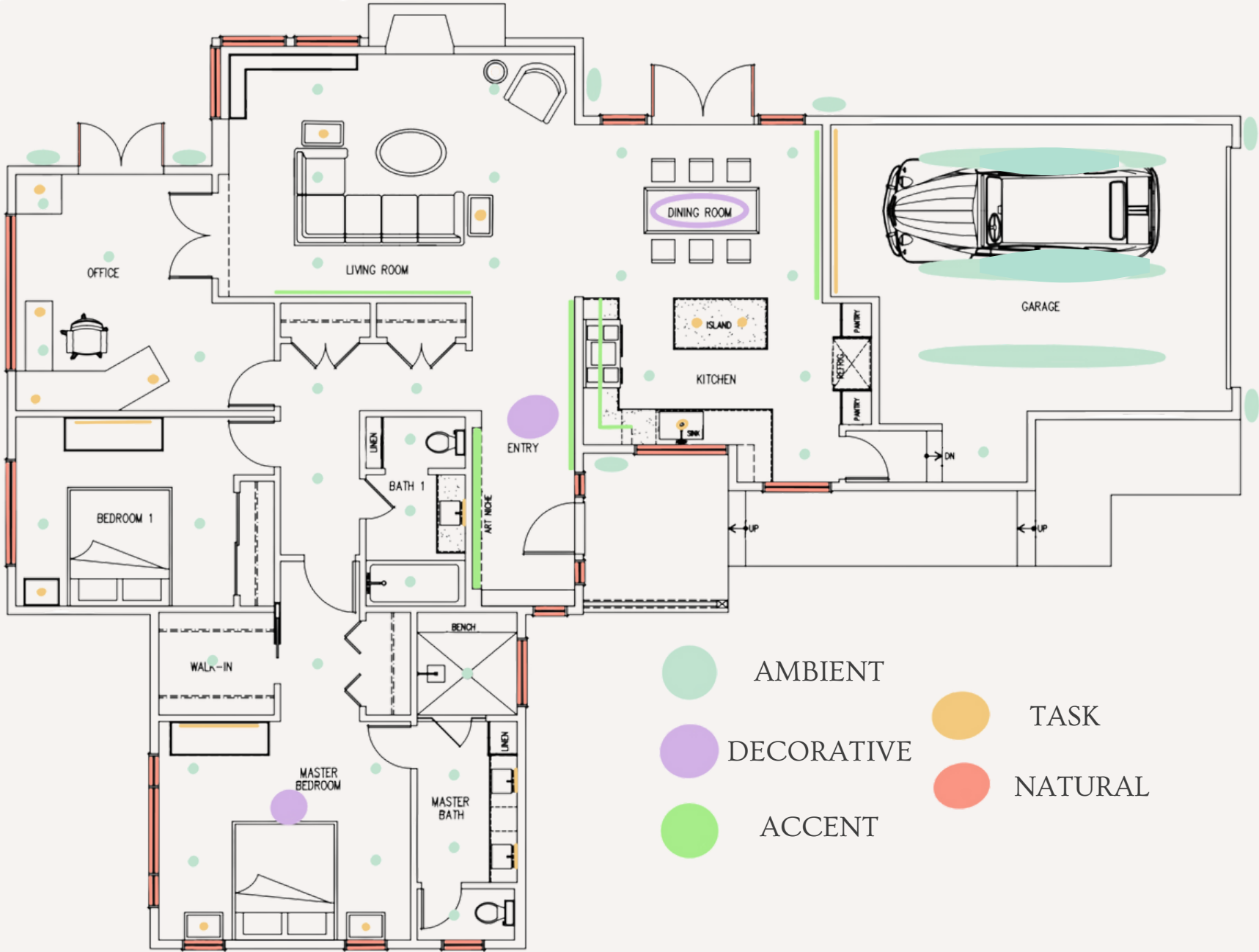

FURNITURE PLAN

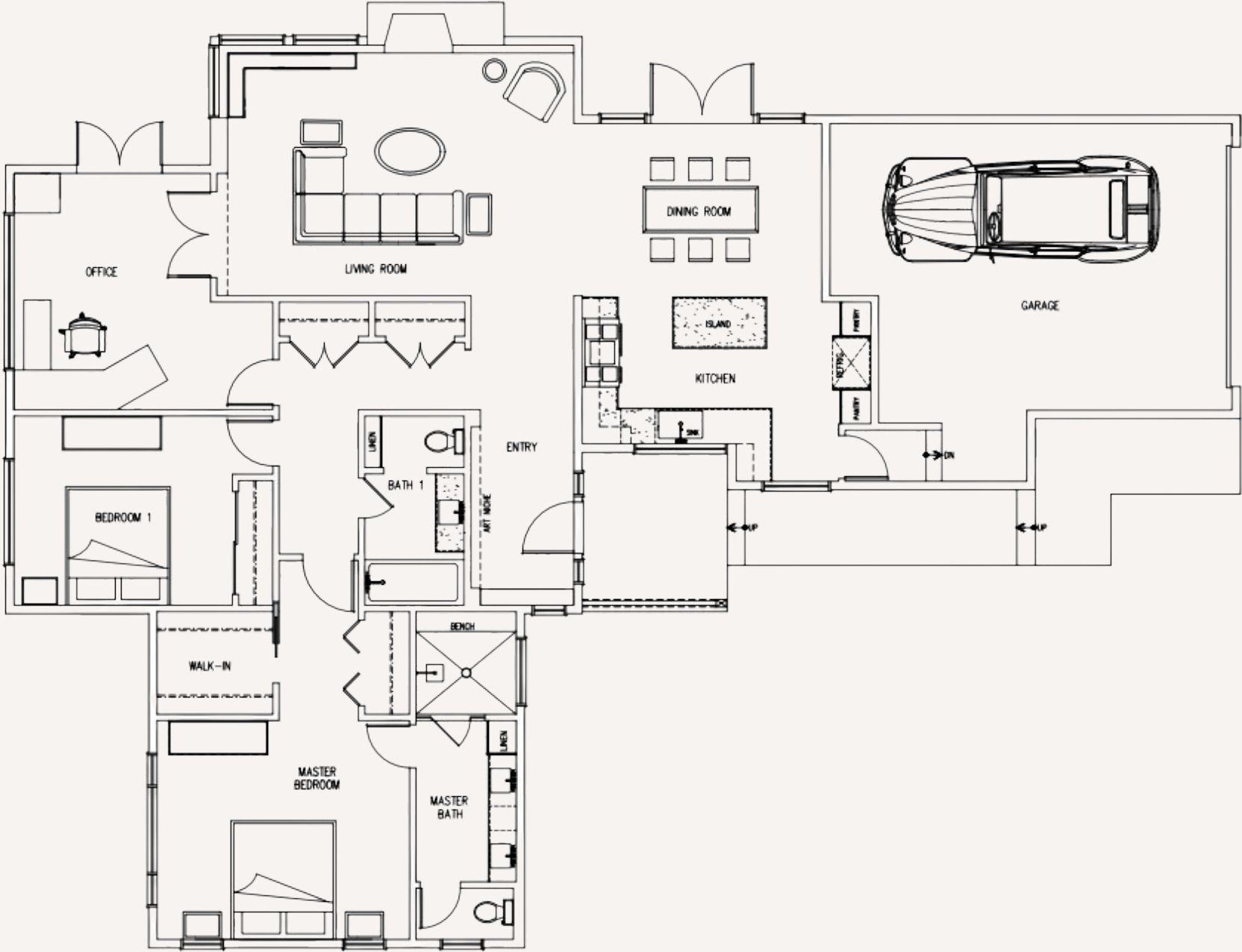

REFLECTED CEILING PLAN

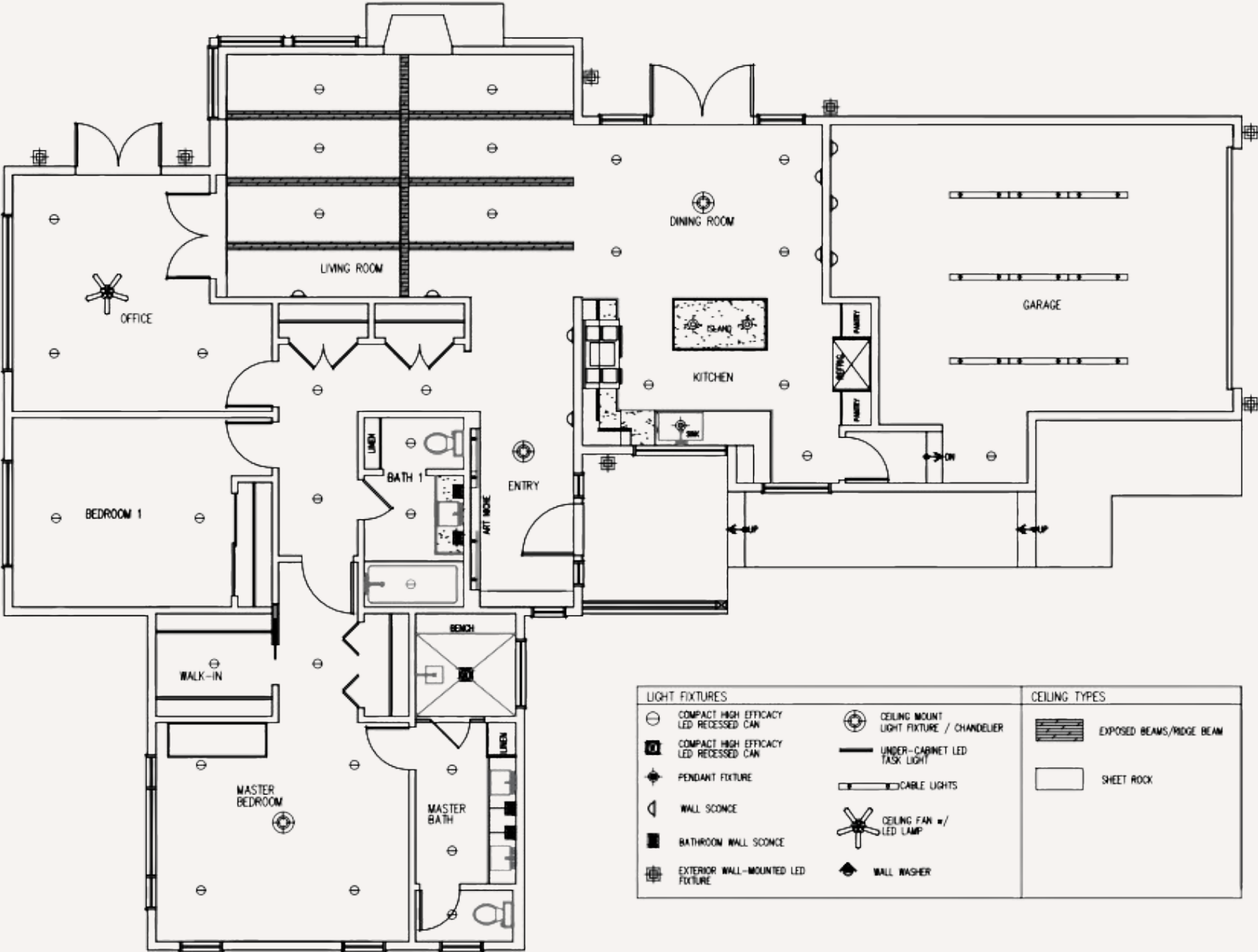

LIGHT FIXTURES		CEILING TYPES
⊖	COMPACT HIGH EFFICACY LED RECESSED CAN	EXPOSED BEAMS/RIDGE BEAM
⊖	COMPACT HIGH EFFICACY LED RECESSED CAN	SHEET ROCK
◆	PENDANT FIXTURE	
◁	WALL SCONCE	
■	BATHROOM WALL SCONCE	
⊞	EXTERIOR WALL-MOUNTED LED FIXTURE	
⊙	CEILING MOUNT LIGHT FIXTURE / CHANDELIER	
—	UNDER-CABINET LED TASK LIGHT	
—	CABLE LIGHTS	
✪	CEILING FAN w/ LED LAMP	
⊞	WALL WASHER	

LIGHTING PLAN

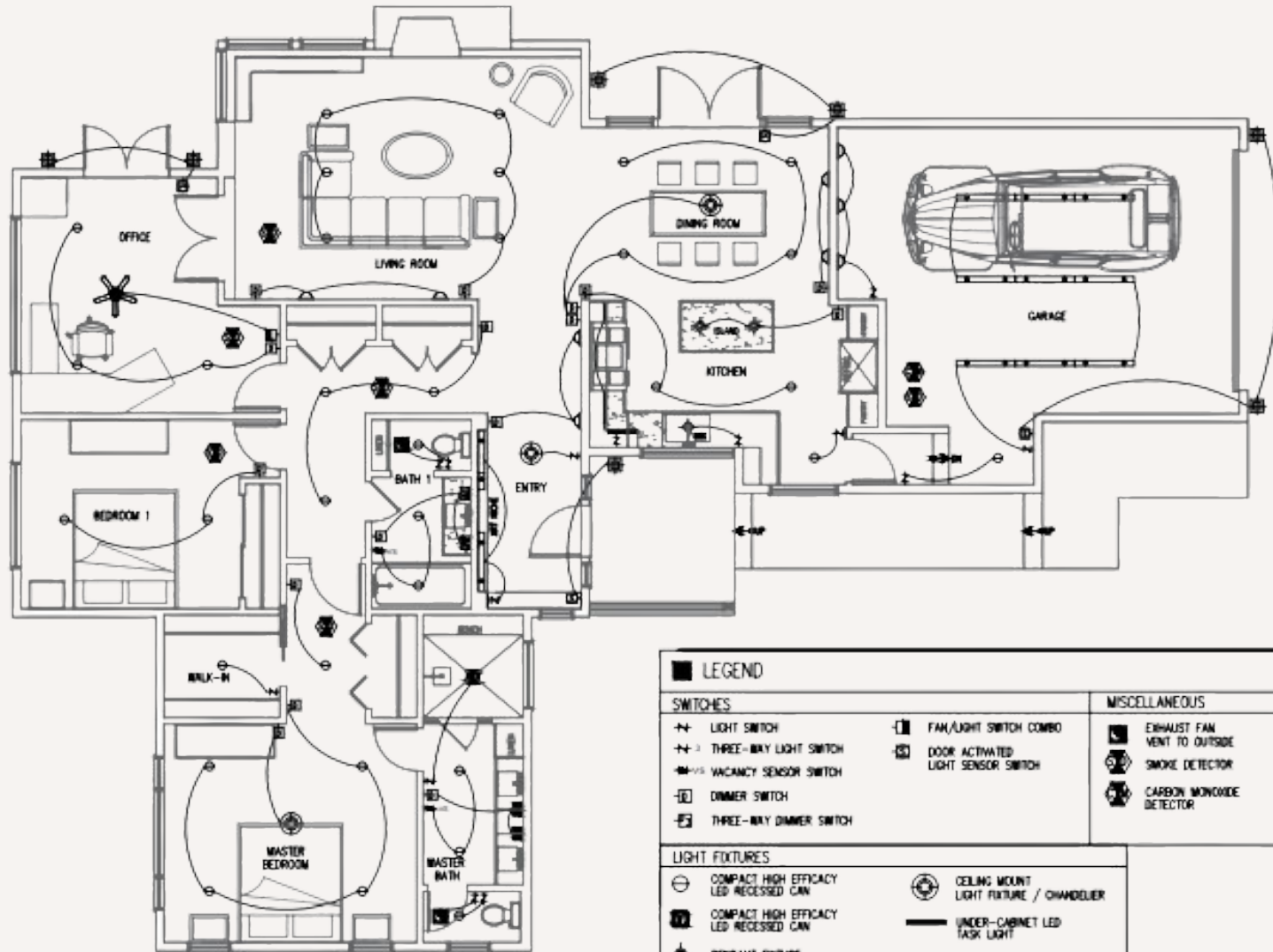

LEGEND		MISCELLANEOUS	
SWITCHES			
⚡	LIGHT SWITCH	⚡	FAN/LIGHT SWITCH COMBO
⚡	THREE-WAY LIGHT SWITCH	⚡	DOOR ACTIVATED LIGHT SENSOR SWITCH
⚡	VACANCY SENSOR SWITCH		
⚡	DIMMER SWITCH		
⚡	THREE-WAY DIMMER SWITCH		
LIGHT FIXTURES			
⊖	COMPACT HIGH EFFICACY LED RECESSED CAN	⊖	CEILING MOUNT LIGHT FIXTURE / CHANDELIER
⊖	COMPACT HIGH EFFICACY LED RECESSED CAN	—	UNDER-CABINET LED TASK LIGHT
◆	PENDANT FIXTURE	—	CABLE LIGHTS
◁	WALL SCONCE	✱	CEILING FAN w/ LED LAMP
◁	BATHROOM WALL SCONCE	◆	WALL WASHER
⊖	EXTERIOR WALL-MOUNTED LED FIXTURE		

MASTER BEDROOM

ELEVATION

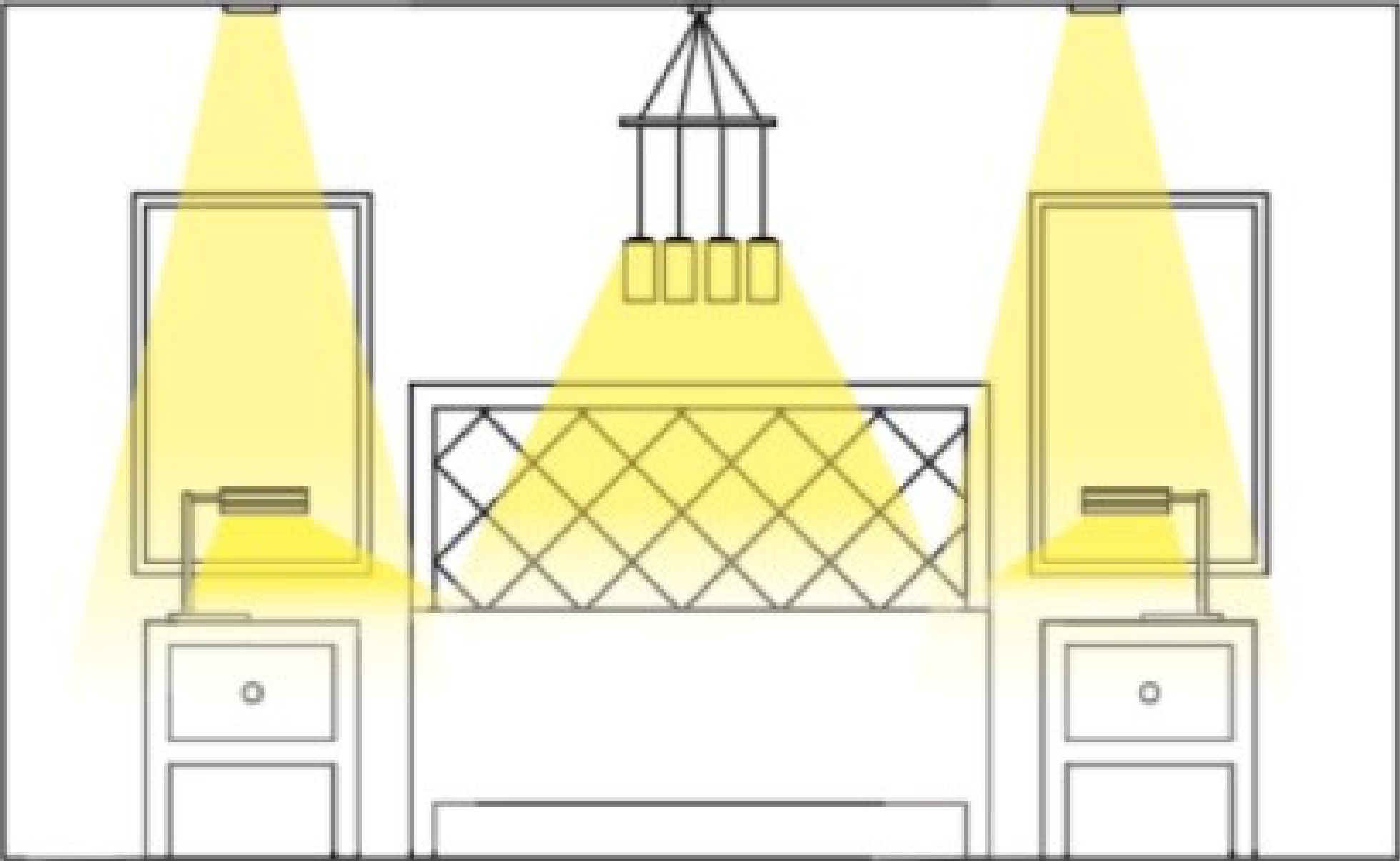

MASTER BATH

ELEVATION

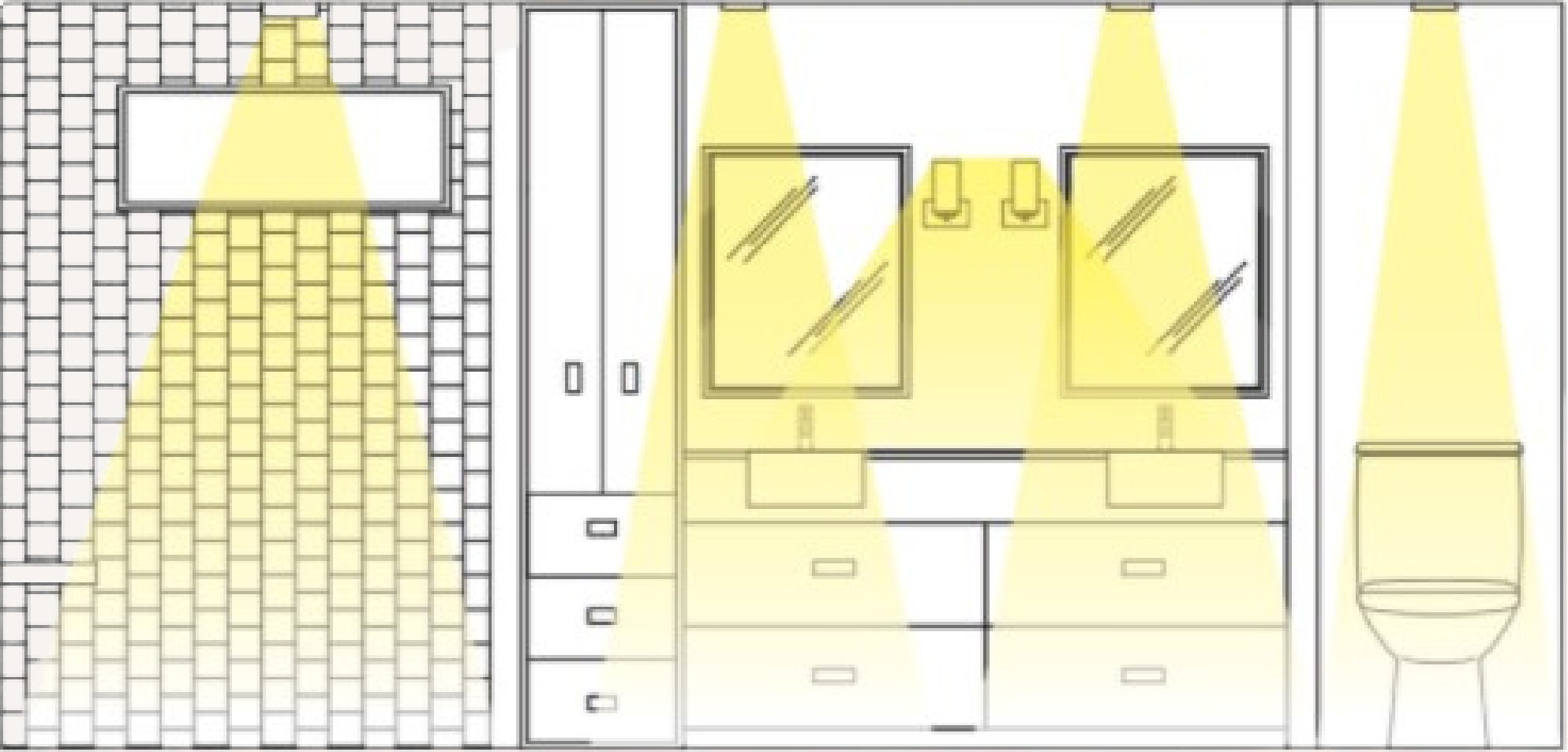

LIVING ROOM

ELEVATION

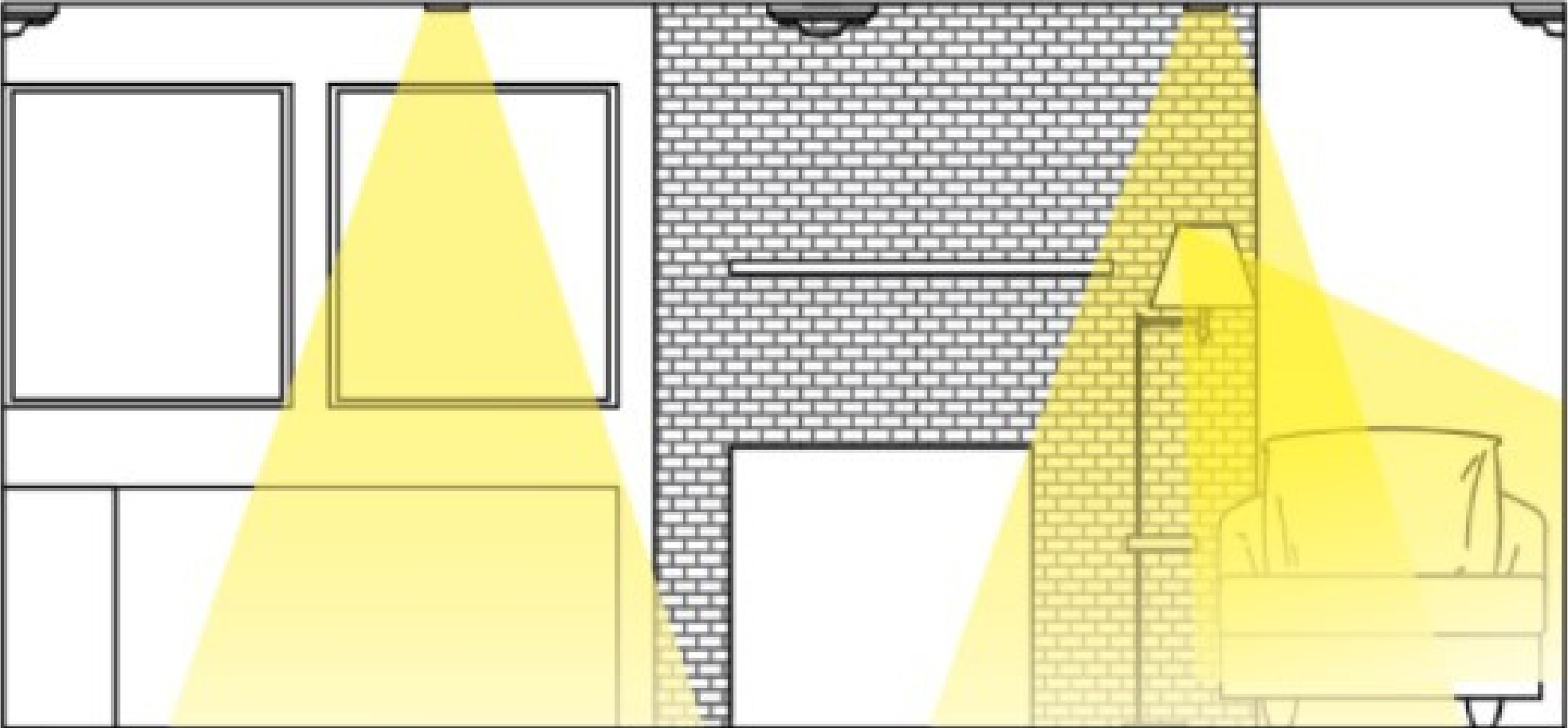



L1

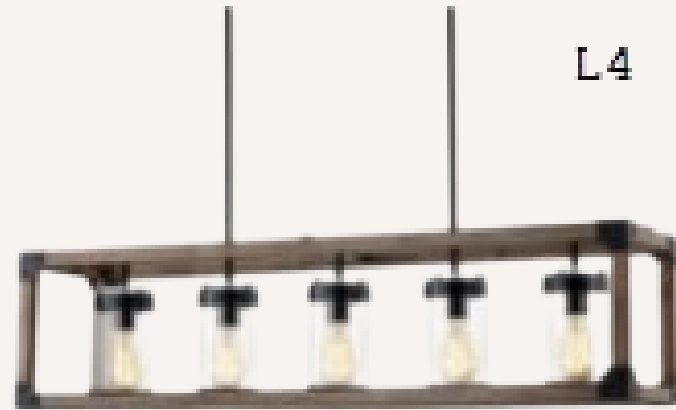

L4



L6



Thank you!

SOPHIA MONFERRATO